

(RoHS) RoHS-Compliant
Motorized Cylinders
EZ limo EZA Series



Stroke 50 mm

High Power



■ High Thrust Force

Optimal for applications where the work is pushed, for example in die sets.

EZA6 (Lead 6 mm)

- Maximum Thrust Force: **400 N**
- Maximum Push Force: **500 N**
(permanent pushing possible)

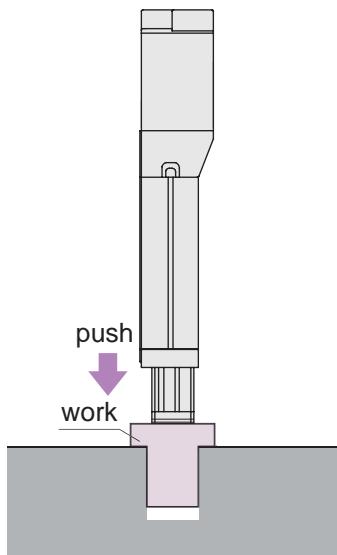

■ Large Transportable Mass

The work can be moved directly without external guide.

EZA6 (Lead 6 mm)

- Maximum Transportable Mass: Horizontal **9 kg***
Vertical **30 kg**

* The maximum horizontal transportable mass changes due to the moment.
* In horizontal operation the maximum horizontal transportable mass can be up to 60 kg by providing an external guide mechanism.

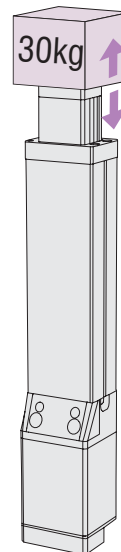

High Speed

■ High Speed

High-speed positioning is possible.

EZA4/EZA6 (Lead 12 mm)

- Maximum Speed: **600 mm/s**
- Sensorless Return to Home at Speed of **100 mm/s**

We have developed a dedicated stop buffer to achieve the sensorless return to home operation at a maximum speed of 100 mm/s.

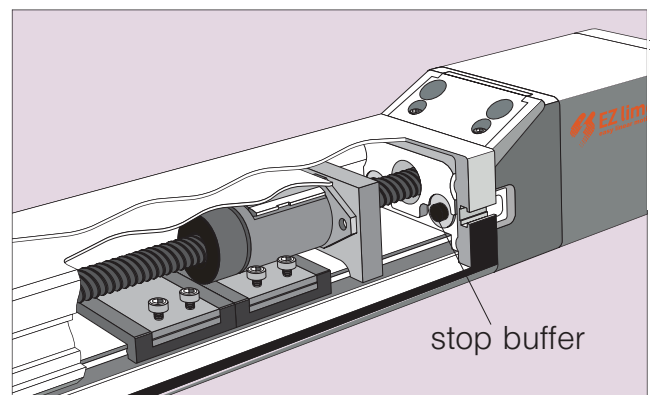

Space-Saving

■ Space-Saving

The shape of the motor cable outlet was changed to eliminate dead space. In relation to the stroke the total length is shorter, enabling a space-saving design of your equipment.

$$\text{Stroke} + 280.5 \text{ mm} = \text{Total Length}$$

■ LM-Guide inside

With the implementation of the LM-Guide within the main body of the cylinder it becomes more compact and easy to use.

● Internal structure

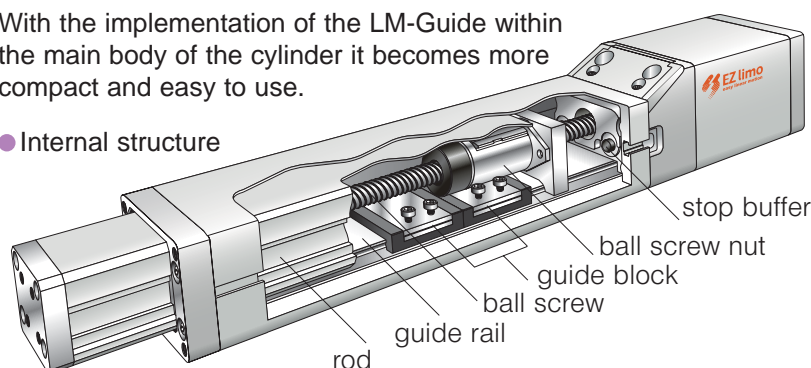

For the ball screw and the LM-Guide the AFF-grease with low dust generation is used, often applied in clean rooms.

- "LM-Guide" is a registered trademark of THK Co., Ltd.

■ Operation without External Guide

There is no need for an external guide mechanism, you can directly transport the mass or conduct a push operation.

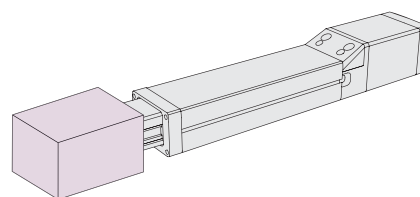

Without external guide

Easy to Install

■ Flexible Mounting

Installation is possible on the rod side and on the base side. Accessories like dual axes mounting plates are sold separately.

● Installation on the rod side

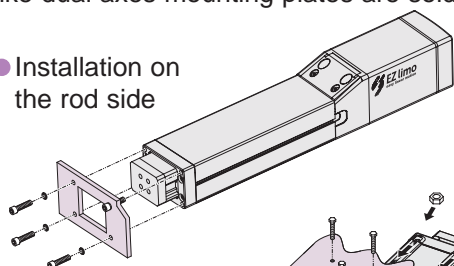

● Installation on the base side

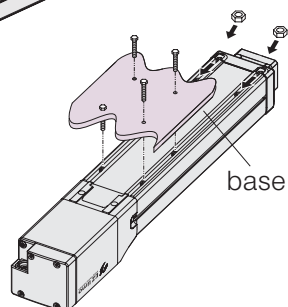

● Installation with mounting plates (sold separately)

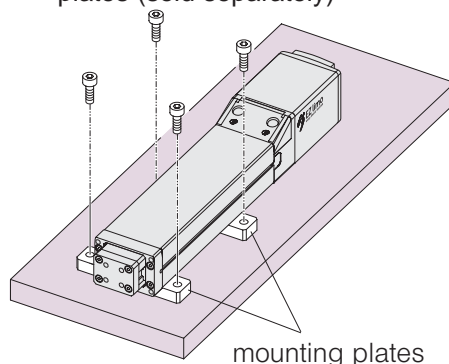

- Easy combination with motorized slide EZS Series to two axes (X-Y). By using the mounting plate (sold separately) the EZA Series can be easily mounted on the table of the motorized slide EZS Series.

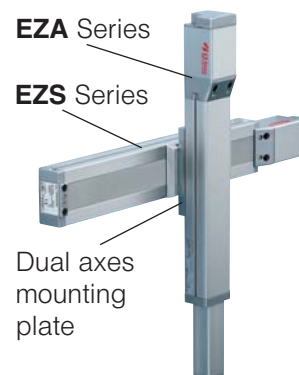

System Configuration

Controller Mode

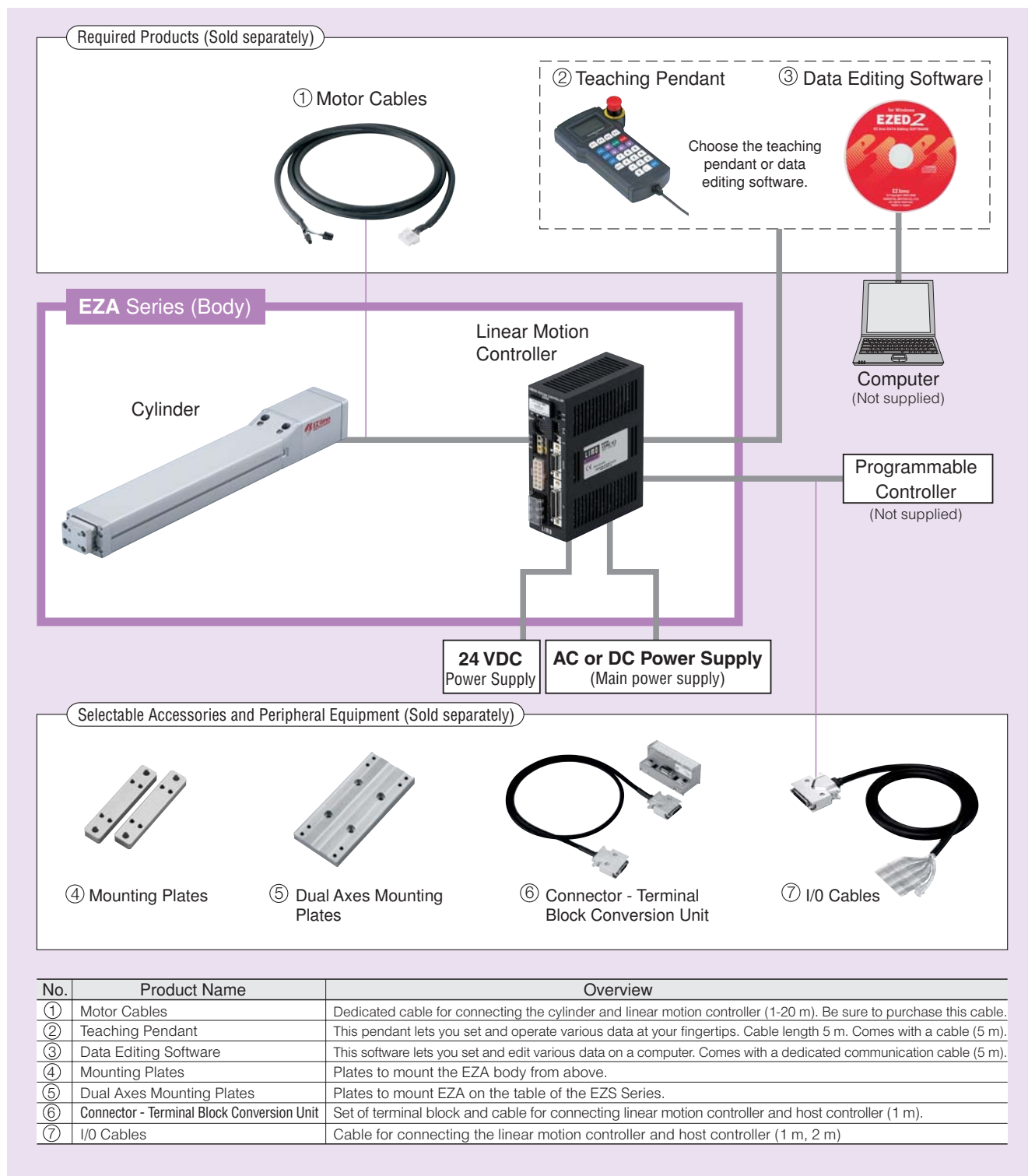

Controller Mode

Body

(Sold separately)

EZA Series	Motor Cable (2 m)	Teaching Pendant			(Sold separately)
EZA4E005-C	CC020ES-2	EZT1	+	Mounting Plate	I/O Cable (1 m)
				PTP-4A	CC36D1-1

● The system configuration shown above is an example. Other combinations are available.

■ Features



Maximum Stroke **300** mm

Maximum Speed **600** mm/s

Maximum Transportable Mass Horizontal **9** kg Vertical **30** kg
Horizontal (with an external guide) **60** kg

Maximum Thrust Force **400** N

Maximum Push Force **500** N

The above figures are representative values. For details, see the product information below.

■ Product Number Code

EZA 4 D 030 M - K

① ② ③ ④ ⑤ ⑥

①	EZA Series
②	Cylinder Size 4 : Frame Size 54 mm x 38 mm 6 : Frame Size 74 mm x 52.5 mm
③	Lead D : 12 mm E : 6 mm
④	Stroke 005 : 50 mm 010 : 100 mm 015 : 150 mm 020 : 200 mm 025 : 250 mm 030 : 300 mm
⑤	Electromagnetic Brake Blank: Without Electromagnetic Brake M : With Electromagnetic Brake
⑥	Power Supply Voltage K : 24 VDC C : Single-Phase 200-230 VAC

■ Product Line

● EZA4

Drive Method	Ball Screw	Repetitive Positioning Accuracy [mm] ± 0.02		Resolution [mm] 0.01			
Model	Lead [mm]	Transportable Mass [kg] with guide		Thrust [N]	Push Force [N]	Electromagnetic Brake Holding Force [N]	Maximum Speed [mm/s]
		Horizontal	Vertical				
EZA4D □-K	12	~15	—	~70	100	—	600
EZA4D □M-K			~6.5			70	
EZA4E □-K	6	~30	—	~140	200	—	300
EZA4E □M-K			~14			140	

Model	Lead [mm]	Transportable Mass [kg] with guide		Thrust [N]	Push Force [N]	Electromagnetic Brake Holding Force [N]	Maximum Speed [mm/s]
		Horizontal	Vertical				
EZA4D □-C	12	~15	—	~70	100	—	600
EZA4D □M-C			~6.5			70	
EZA4E □-C	6	~30	—	~140	200	—	300
EZA4E □M-C			~14			140	

● EZA6

Drive Method	Ball Screw	Repetitive Positioning Accuracy [mm] ± 0.02		Resolution [mm] 0.01			
Model	Lead [mm]	Transportable Mass [kg] with guide		Thrust [N]	Push Force [N]	Electromagnetic Brake Holding Force [N]	Maximum Speed [mm/s]
		Horizontal	Vertical				
EZA6D □-K	12	~30	—	~200	400	—	600
EZA6D □M-K			~15			200	
EZA6E □-K	6	~60	—	~400	500	—	300
EZA6E □M-K			~30			400	

Model	Lead [mm]	Transportable Mass [kg] with guide		Thrust [N]	Push Force [N]	Electromagnetic Brake Holding Force [N]	Maximum Speed [mm/s]
		Horizontal	Vertical				
EZA6D □-C	12	~30	—	~200	400	—	600
EZA6D □M-C			~15			200	
EZA6E □-C	6	~60	—	~400	500	—	300
EZA6E □M-C			~30			400	

● EZA4

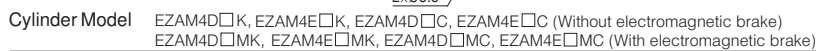

● EZA6

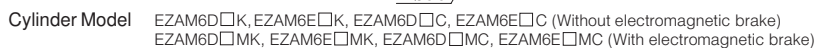
6

■ Mounting Plates (RoHS)

Plates to mount the EZA body from above. Screws to fix the plates at the EZA body are included (usage of T-slots). Please provide the screws to fix them to the device by yourself.

● Product Line

Model	Applicable Product	Mass (g)
PTP-A4	EZA4	80
PTP-A6	EZA6	100

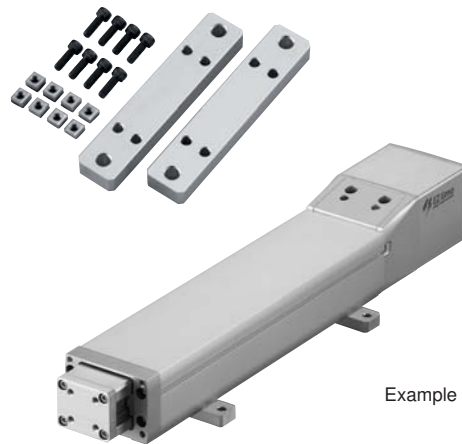

Example

● Dimensions (Unit = mm)

PTP-A4

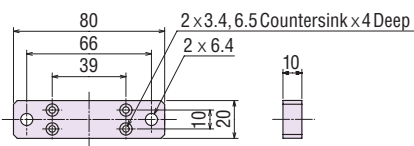

PTP-A6

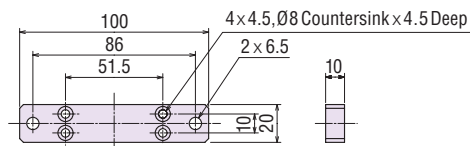

■ Dual Axes Mounting Plates (RoHS)

This product is for an easy mounting of the EZA Series on the table of the motorized slide EZS Series.

Model	Applicable Product	Mass (g)
PAB-S4A4	Combination of EZS4 and EZA4	150
PAB-S6A4	Combination of EZS6 and EZA4	170
PAB-S6A6	Combination of EZS6 and EZA6	205

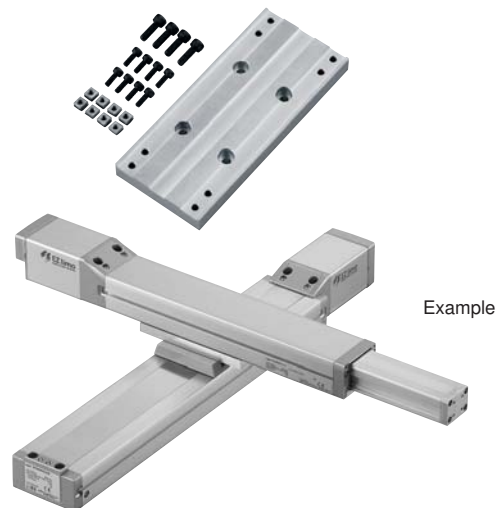

Example

● Dimensions (Unit = mm)

PAB-S4A4

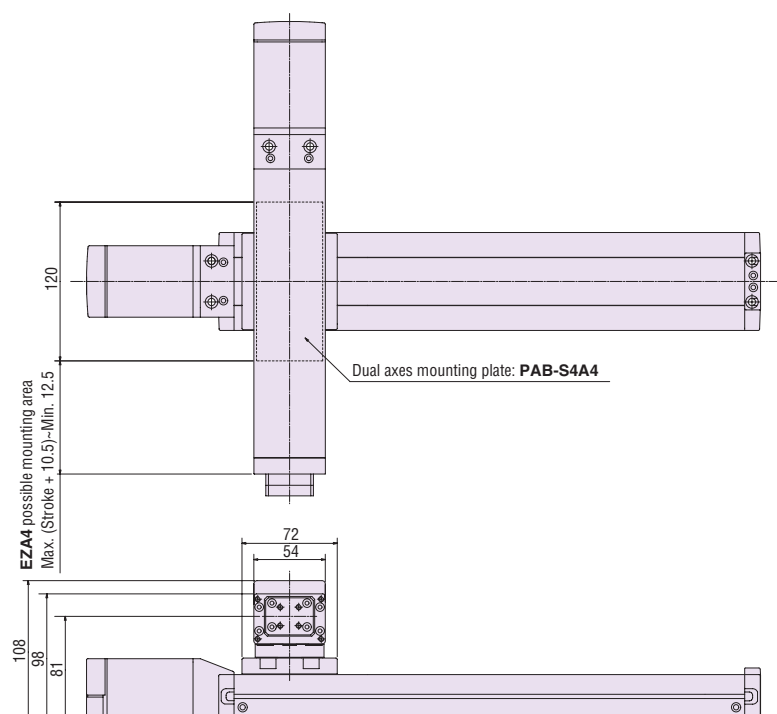
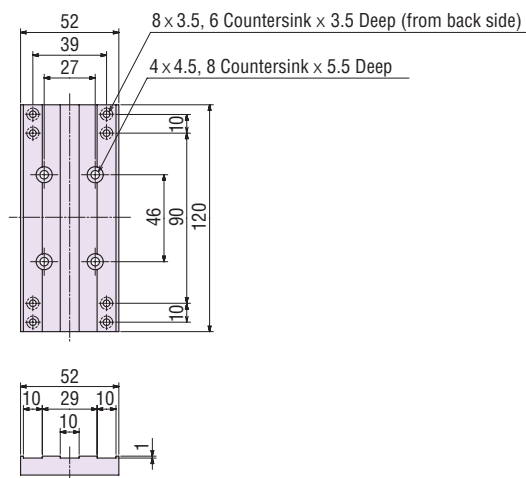

■ Dimensions (Unit = mm)

● PAB-S6A4

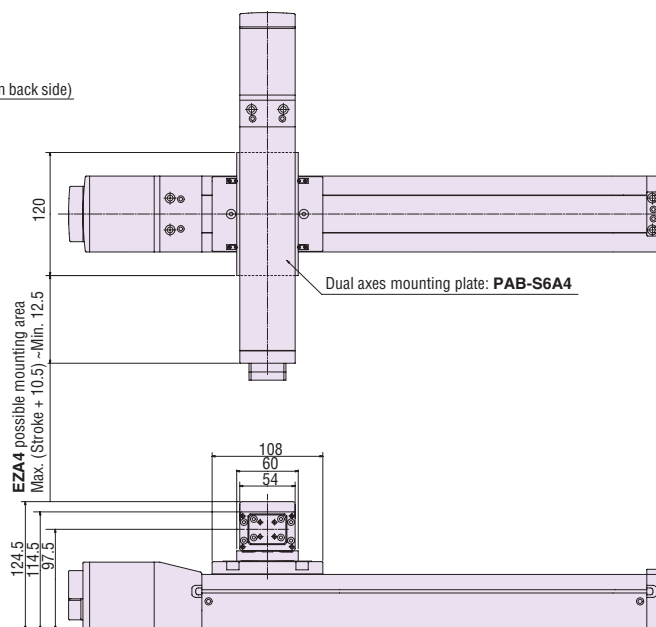
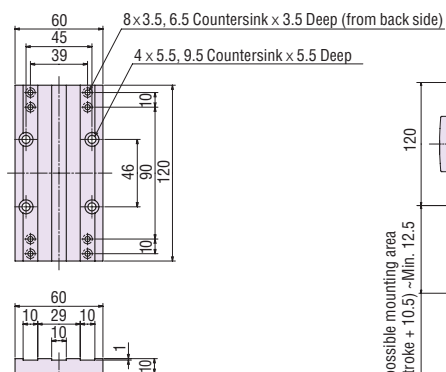

● PAB-S6A6

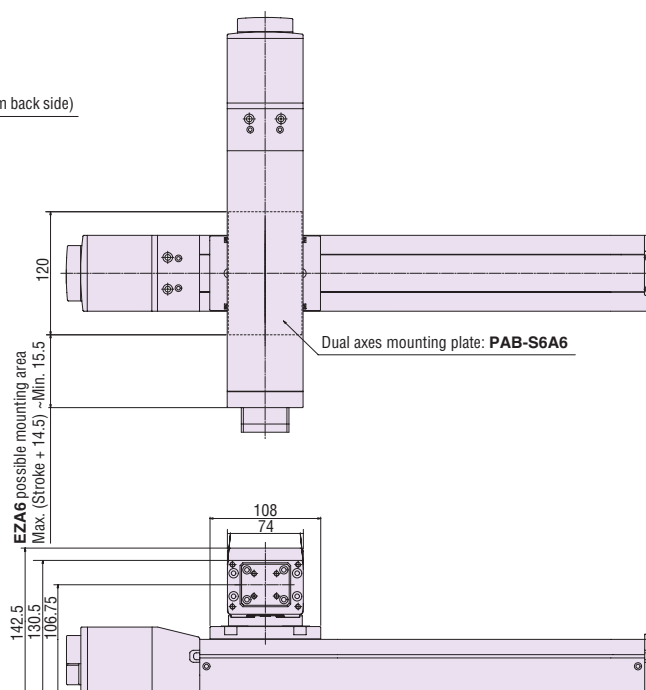
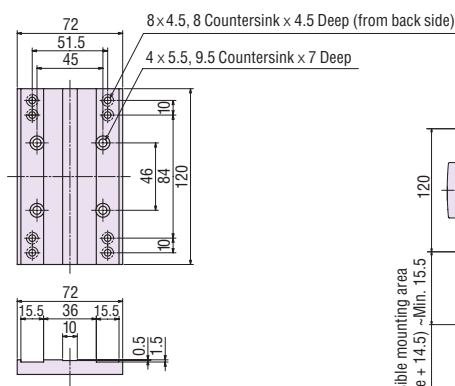

This product is manufactured at a plant certified with the international standards **ISO 9001** (for quality assurance) and **ISO 14001** (for systems of environmental management).

Specifications are subject to change without notice.

This catalogue was published in November, 2009.

Orientalmotor

ORIENTAL MOTOR (EUROPA) GmbH

www.orientalmotor.de

European Headquarters and Düsseldorf Office

Schiesstraße 74
40549 Düsseldorf, Germany
Tel: 0211-5206700 Fax: 0211-52067099

ORIENTAL MOTOR (FRANCE) SARL

www.orientalmotor.fr

France Headquarters

32, Avenue de l'île Saint Martin
92737 Nanterre Cedex, France
Tel: 01 47 86 97 50 Fax: 01 47 82 45 16

ORIENTAL MOTOR (UK) LTD.

www.oriental-motor.co.uk

Unit 5, Faraday Office Park,
Rankine Road, Basingstoke,
Hampshire RG24 8AH U.K.
Tel: 01256-347090 Fax: 01256-347099

ORIENTAL MOTOR CO., LTD.

www.orientalmotor.co.jp

Headquarters

16-17, Ueno 6-chome
Taito-ku, Tokyo 110-8536, Japan
Tel: (03)3835-0684 Fax: (03)3835-1890

ORIENTAL MOTOR ITALIA s.r.l.

www.orientalmotor.it

Italy Headquarters

Via A. De Gasperi, 85
20017 Mazza di Rho (MI), Italy
Tel: 02-93906346 Fax: 02-93906348

For more information please contact: